

Internet Hub Instruction Manual

For model:
JGHUB2



www.speedfitUFH.co.uk

Box Contents



JGHUB2



USB Cable



Ethernet Cable



Instruction Manual



Screws and Plugs

Disclaimer

Customers that choose to operate their heating remotely using JG Aura Range technology via their personal computer, tablet or smart phone device(s) will be entering into a contract with Salus Controls plc ("Salus"), which is a third party supplier of the software. John Guest Ltd and affiliates within the John Guest group of companies from time to time (the "John Guest Group") make no representations or warranties of any kind about the reliability or suitability of the software or applications provided by Salus. The John Guest Group disclaims liability (excluding liability for death and personal injury resulting from negligence) for any loss or damage caused by the software provided to customers by Salus. Any agreement entered into with Salus is therefore strictly at your own risk.

John Guest Speedfit Limited

Horton Road, West Drayton, Middlesex UB7 8JL, England.

Tel: 01895 449233 Fax: 01895 420321 www.speedfitUFH.co.uk Technical Help Desk: 01895 425333

JG John Guest® and Speedfit®

The above names are all trademarks of John Guest International Limited.

© John Guest International Limited 2014. All rights reserved.

Z2105/419/1114

1 Remove the Coordinator



Power Adapter



Remove JGCO

2 Insert the Coordinator in to the Hub

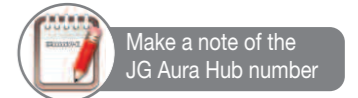

Make a note of the JG Aura Hub number



Connect the Hub to the internet using one of the methods below

A Using Ethernet Cable

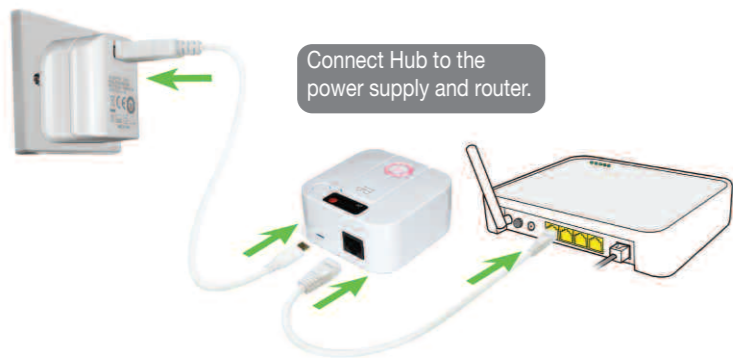

Connect Hub to the power supply and router.

OR B Using WPS Button on Router

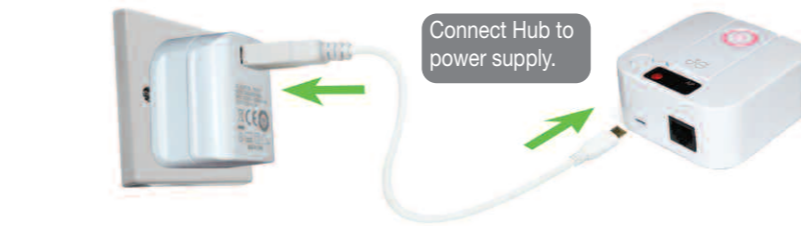

Connect Hub to power supply.

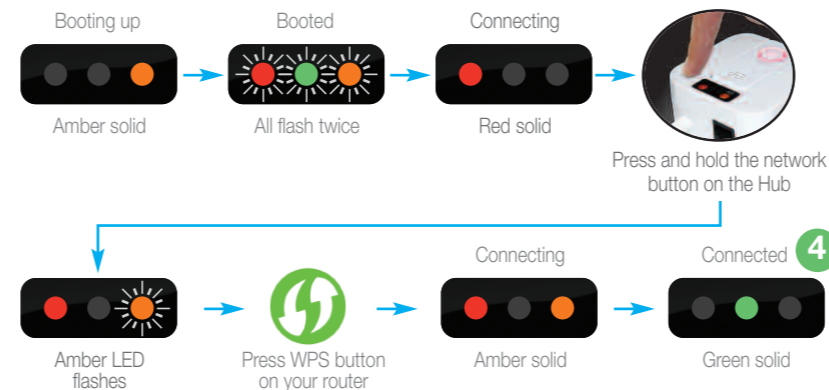

After power up you will see

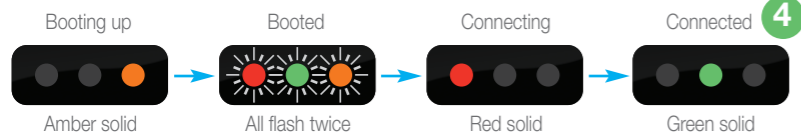

Download the free App

The JG Aura App is compatible with iOS, Android and Windows phones.



Press on LOGIN

Press on Create an Account

Complete the Registration and press SUBMIT

@ Once registered, you will receive a confirmation email.

Register your first JG Aura Hub

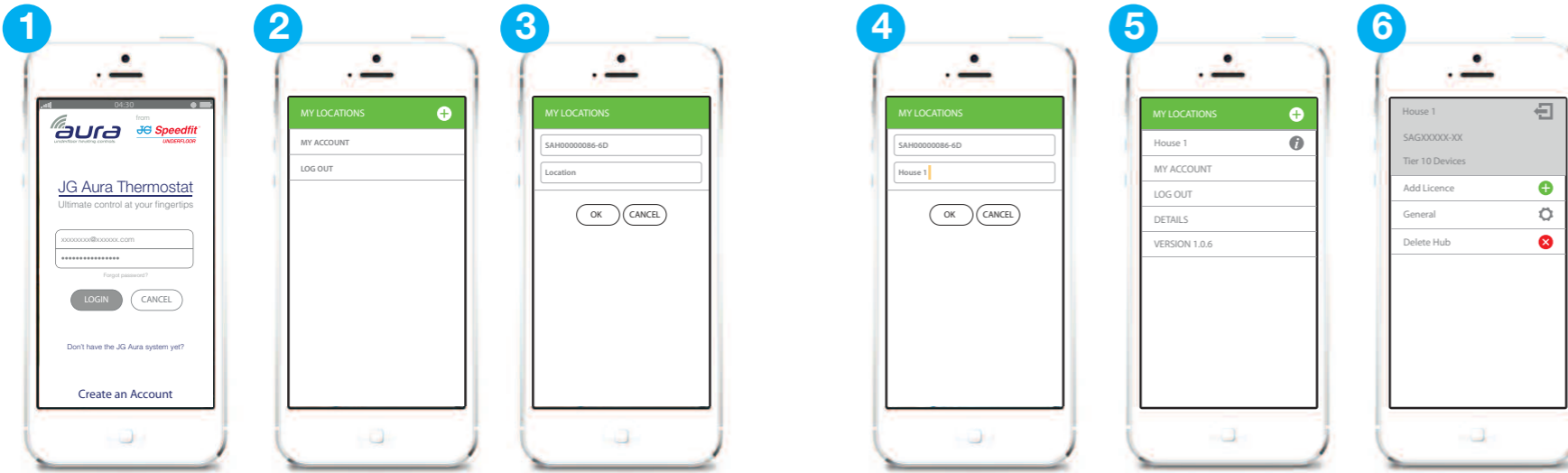

1 After you have received the confirmation email, you can now log in.

2 Once logged in you will be asked to add your first Hub (location). Click on the **+** icon.

3 Enter the Hub number that you made a note of earlier.

4 Enter a location name of your choice.

5 Congratulations, you have now added your Hub to the device list. To see information on a particular Hub, simply click on the **i** icon.

6 From here you can access information for the selected location.

Additional User Licence Cards

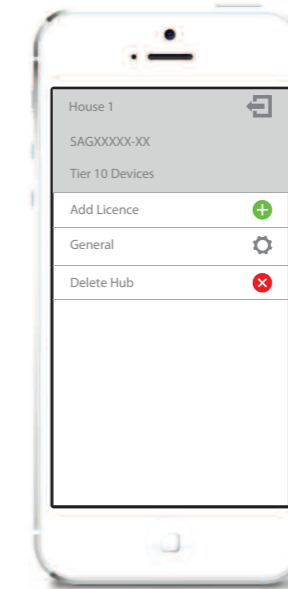

The JG Aura Hub comes pre-installed with the ability to connect up to 10 thermostats. If you want to connect more, you must buy a JG Aura User Licence card.

Each User Licence card supports an additional 10 thermostats. The JG Aura Hub (with licences) can support a maximum of 30 thermostats.

Location Overview Page

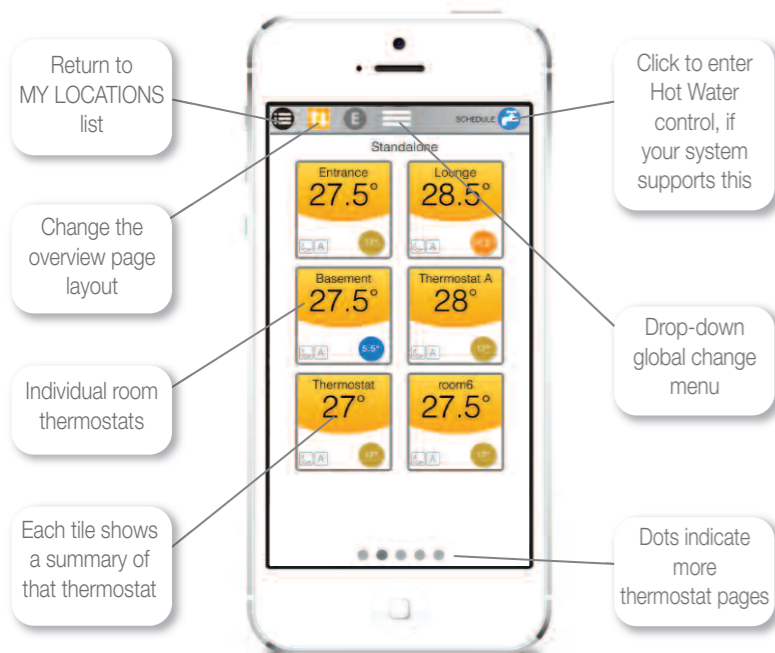

Thermostat Control Page

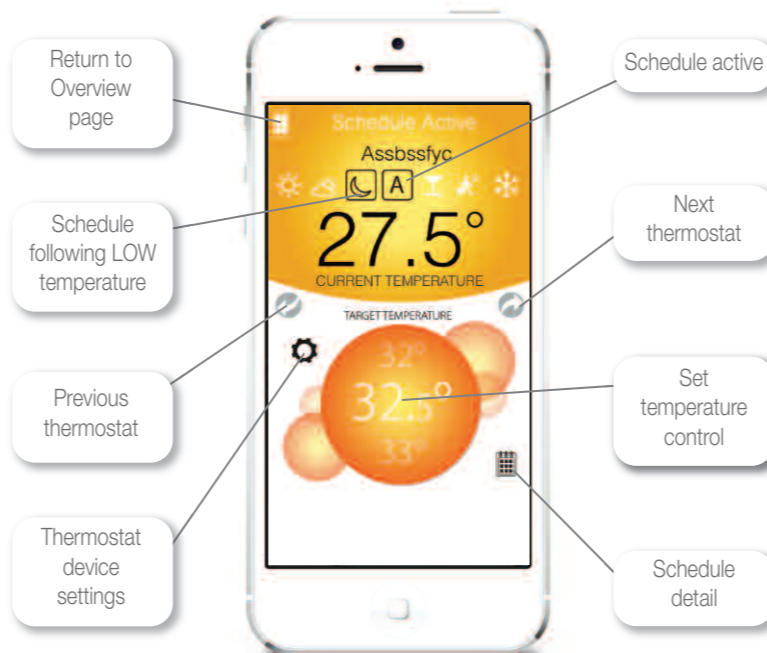

Hot Water Control Page (if applicable)

